



# S100

## Reach-In Storage Freezers



### Capacity

- 90 Cubic Feet (approx.)

### Outside Dimensions

- 94"W x 35½"D x 76½"H

### Attributes

- 27" x 55" Durapon Coated Steel Doors
- 3/4 Horsepower Compressor
- Amperage: Auto Defrost 13
- 0°F Operating Temperature
- R404A Refrigeration

### Models Available

- Indoor
- Outdoor

### Standard features:

- Water-tight lock-form seam construction for a stronger and more durable cabinet with all steel construction.
  - Premier quality construction with the straightest edges and minimal foam bleed.
  - 'Box Frame' constructed for optimal strength and increased resistance to freight damage.
- Hot-dipped galvanized top-coated steel door with premium fluorocarbon paint system.
- Low temperature sealed condensing units.
- Two-part acrylic polyurethane coating offers mid-range gloss and excellent weather ability. Epoxy primer formulated to have excellent adhesion and corrosion and humidity resistance.
- 0°F operating temperature.
- PVC bottom skid plates for non-marking of floor surfaces.
- Door openings feature high impact vinyl breaker strips to provide better impact resistance and greater durability to handle harsh conditions.
- Drain plug - recessed drain for easier and complete water draining.
- Easily accessible refrigeration service valves.
- Drop-down unit cooler allows ease of service.
- Electronic temperature controls.
- Pilaster style shelving, 8 shelves (4 per side)
  - 43"W x 28"D
  - 100 lb. capacity per shelf

### Options

- Bumper guards
- Diamond plate trim
- Call for additional options! (800)-766-5337

# S100

## Reach-In Storage Freezers

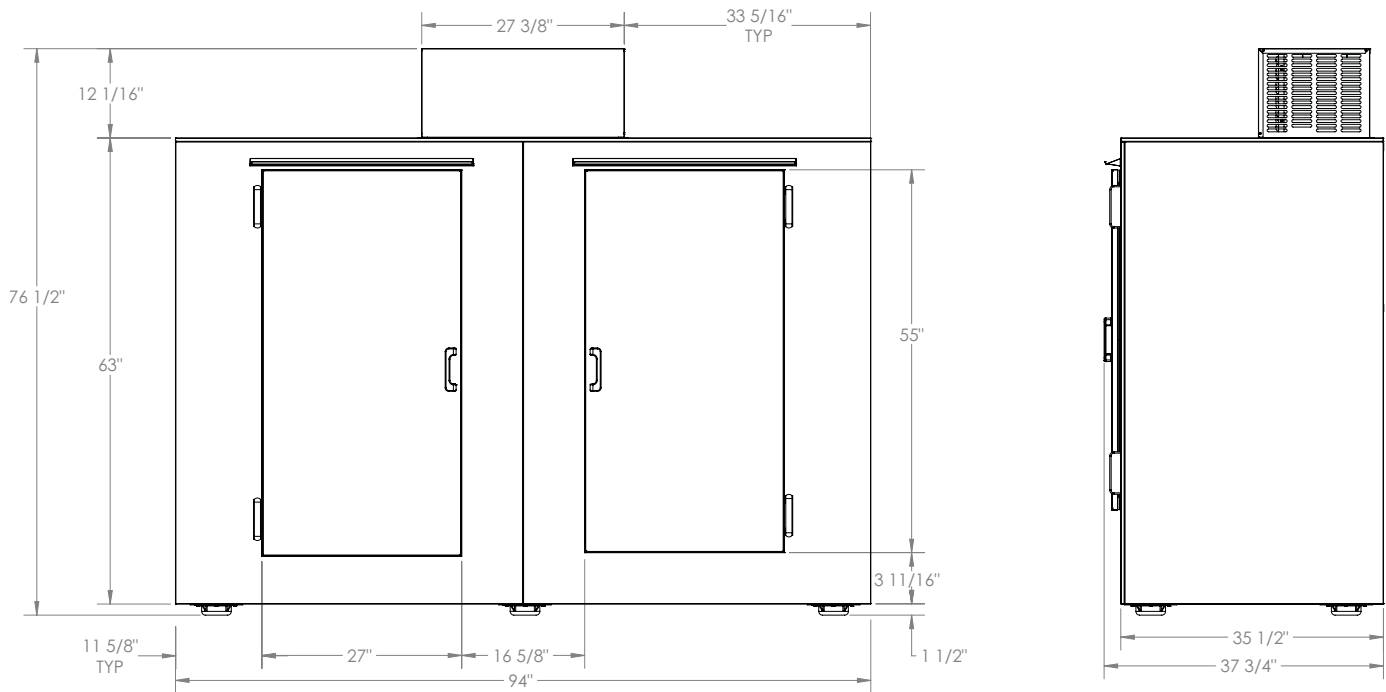

Auto Defrost Shipping Weight 560 lbs. (approx.)

We maximize efficiency in our efforts to be **Green** 

- 3" insulation for increased R value over other brands
- Inset 2" solid (one-piece PVC) welded reinforced door
- Leer merchandisers meet Department of Energy (DOE) energy conservation standards
- Recyclable shipping materials
- NSF Approved indoor and outdoor units now available

Leer has been designing, building and improving ice merchandisers since 1952. We keep a large inventory of finished goods and replacement parts on hand at all times. Over 50 models of merchandisers, including cash-less self-vending machines are available from stock and through our distribution partners.



*An Employee Owned Company*

**Leer Inc.**  
 206 Leer St.  
 New Lisbon, WI 53950  
 Phone: 800.766.5337  
 Fax: 608.562.6022  
[www.leerinc.com](http://www.leerinc.com)